

BUILDING No. 7:

2,100 square feet of commercial space available. Stand-alone post and beam masonry structure.

BUILDING No. 8:

9,000 square feet of commercial space. Two-story post and beam masonry structure.

BUILDING No. 4:

2,800 square foot single-story stand-alone commercial building.

BUILDING No. 3:

40,000 square feet of post and beam commercial office space available. Offers floor to ceiling historic windows and original hardwood flooring. Also houses 42 high-end loft apartments on the top 3 floors.

BUILDING No. 3A:

Home of Seven Stars Bakery, this open store front retail space has a covered walkway and offers 3,000 square feet of space.

BUILDINGS No. 2 & 9:

3,000 square feet of retail/office space with an adjacent walkway. Features 14 foot exposed ceilings with a post and beam structure.

BUILDINGS No. 1 & No. 10:

Circa 1890's, this was the main site for the manufacture of Rumford's namesake products. This will now be the site of 46 loft apartments that feature brick walls and oversized windows.

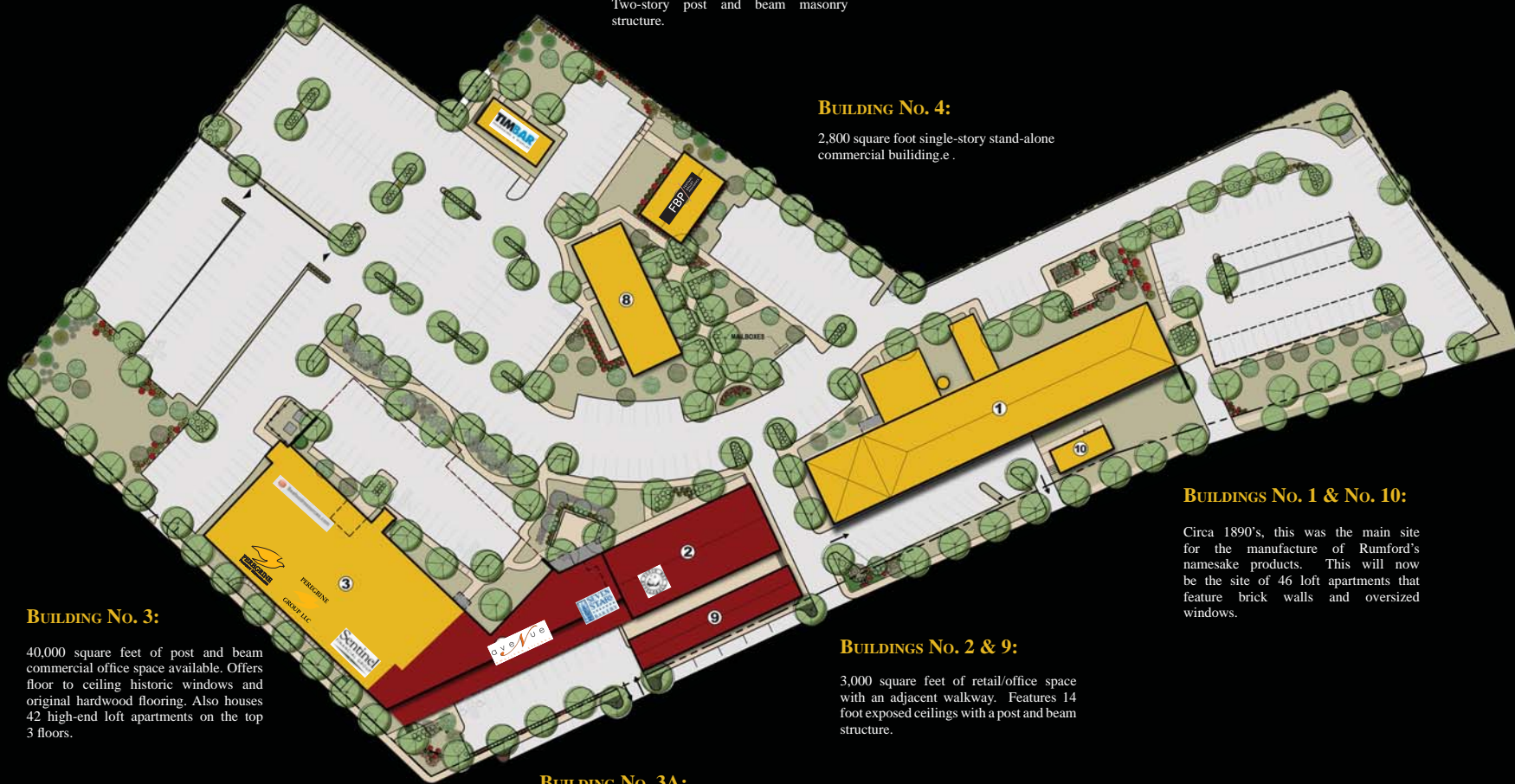

Peter Hayes - 401.273.1980 - PHayes@hayessherry.com
Matt Fair - MFair@hayessherry.com

COMMUNITY SITE PLAN



RUMFORD CENTER